

8 7 6 5 4 3 2 1

REVISIONS				
REV	DATE	DESCRIPTION	BY	ECD
A	10/8/13	RELEASED TO PRODUCTION	ATM	7657

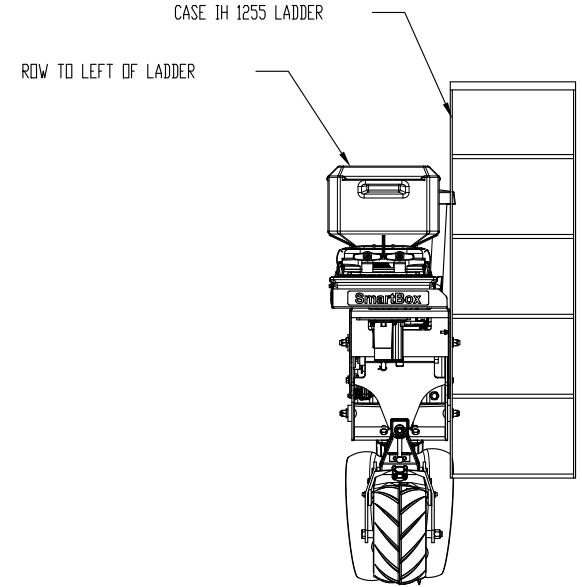
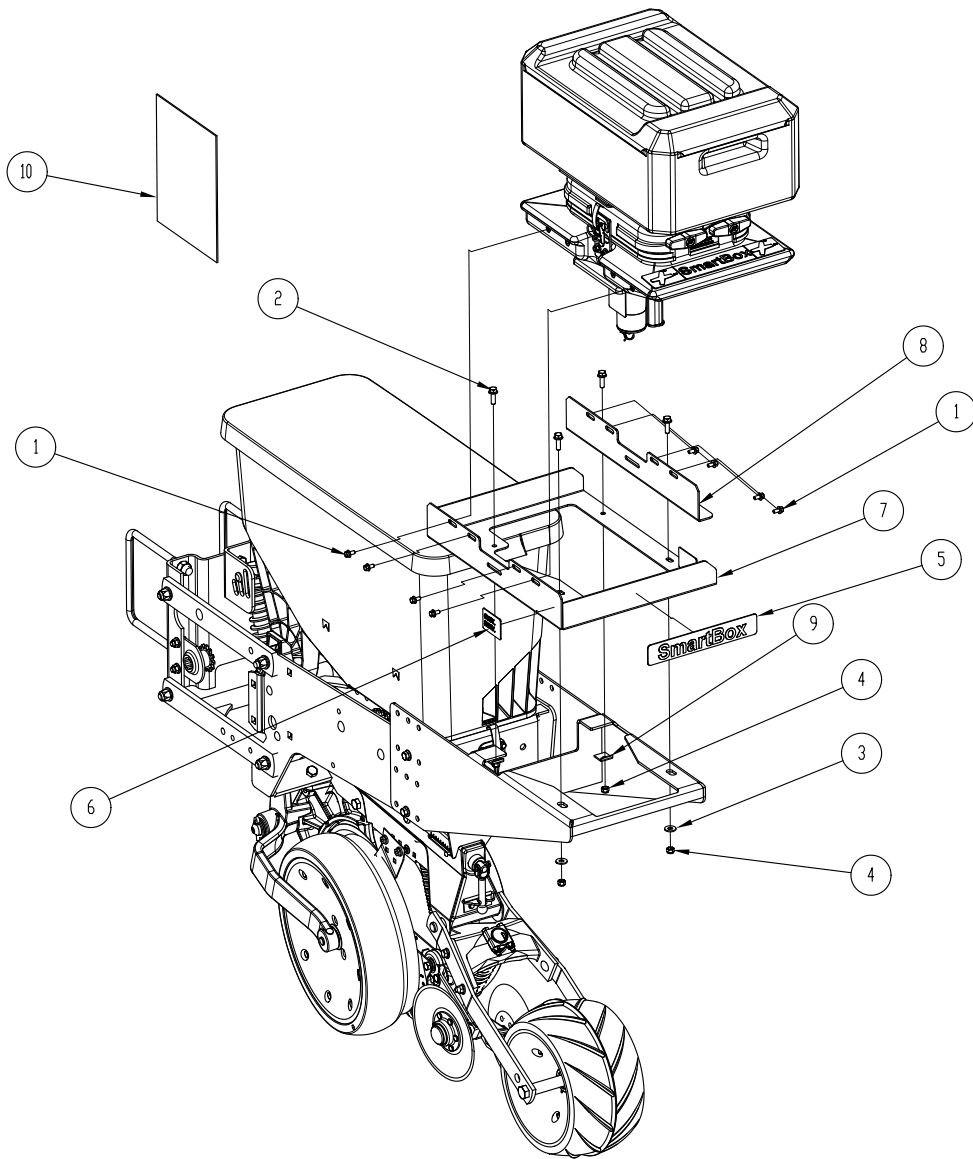

NOTE:	ITEM NO.	QTY.	PART NUMBER	DESCRIPTION
	10	1	WF-2014-64	LIT; LH LADDER, CASE IH 1255
X	9	2	SBC-010	CRADLE MOUNTING CLIP
	8	1	SB021627	BRACKET; SIDE SHORT
	7	1	SB021625	BRACKET; SIDE LONG
	6	2	SB1205	LABLE; CUST SERV. 1.75 X 2.5
	5	1	SB1202	SMARTBOX LABEL
X	4	4	LN-031-NI	LOCKNUT, NYLON INSERT; 5/16", GR5
X	3	2	FW-031	WASHER, FLAT; 5/16"
X	2	4	BHF-031-100-5	BOLT, FLG; 5/16"x1" GR 5
X	1	8	BHF-025-050-5	BOLT, FLG; 1/4"x1/2" GR 5

NOTES:
X = ITEMS INCLUDED IN PARTS BAG SUBASSEMBLY, OR DIFFERENT LINE ITEM.

MATERIAL: Material (not specified)		APPROX. WEIGHT: 142.28LBS
DIMENSIONS ARE IN INCHES		
TOLERANCES (EXCEPT AS NOTED)		
2 PLACE DECIMALS ± .06		
3 PLACE DECIMALS ± .030		
ANGLES ± 1°		
THIRD ANGLE PROJECTION		DESCRIPTION: ASSY; LH LADDER, CASE IH 1255
DRAWN: ATM		TWG NO: SB021632
SIZE: B	DATE: 10/28/13	SCALE: N/A
SHEET 1 OF 1		REV: A

8 7 6 5 4 3 2 1